

1) ANCILLARY SHED PLAN

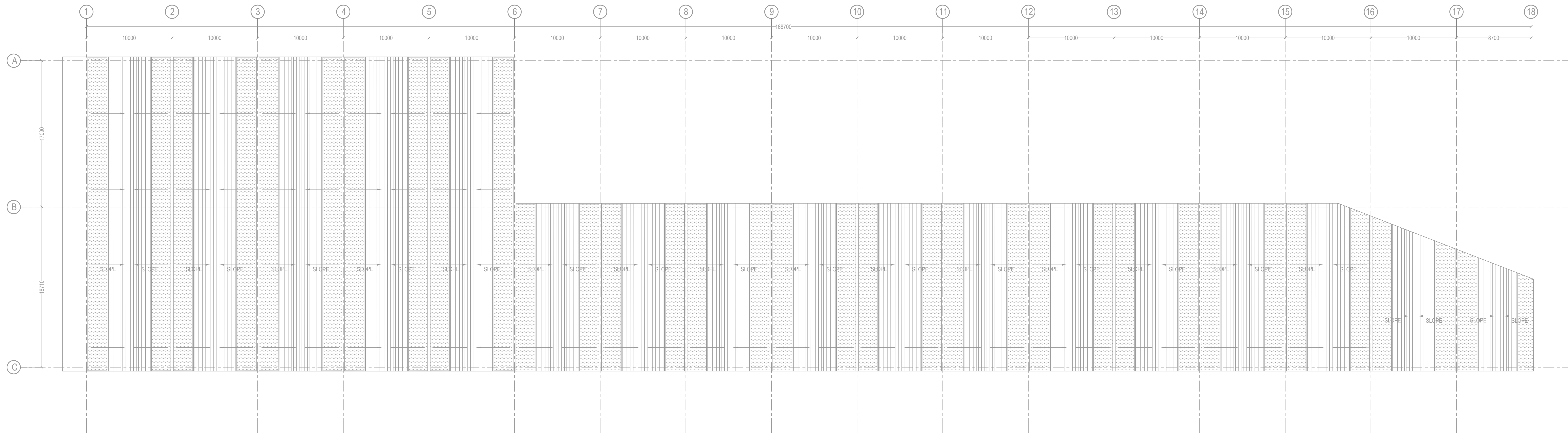

2) ANCILLARY SHED ROOF PLAN

- THIS DRAWING IS FOR INFORMATION AND REFERENCE AS A GENERAL GUIDANCE ONLY.
- ALL DEPOT FACILITIES, PLANTS & MACHINERIES, ACCOMMODATION FACILITIES, SYSTEM WIDE REQUIREMENTS ETC SHALL BE VERIFIED FOR MAINTENANCE REQUIREMENT OF ROLLING STOCK AND INFRASTRUCTURE FACILITIES.
- ALL DIMENSIONS ARE IN METER UNLESS NOTED OTHERWISE AND TO BE READ ONLY NOT MEASURED.
- ABSOLUTE RAIL LEVEL SHALL BE DERIVED FROM APPROVED ALIGNMENT DRAWINGS. STRUCTURE SYSTEM SHOWN IS INDICATIVE. ALL STRUCTURE MEMBER SIZES TO BE DETAILED BY DESIGNER AT LATER STAGE.
- THIS DRAWINGS HAVE BEEN DEVELOPED IN CONFORMITY TO DPR, S.O. & BSRP. OTHER COAL REQUIREMENTS.
- SYSTEM ROOM SIZES, HEIGHTS, DOOR SIZE, FLOOR HEIGHT AND CUTOFF DIMENSIONS TO BE VERIFIED BY RELEVANT DISCIPLINES OF ENGINEERING.
- SHAFTS FOR ELECTRICAL, SAT, PLUMBING, DRAINAGE, SEWAGE DISPOSAL, RAIN WATER HARVESTING, FIRE AND OTHER SYSTEMS SHALL BE PROVIDED AS PER SYSTEM AND MEP REQUIREMENTS.
- ALL FINISHES ARE SUBJECT TO K-RIDE APPROVAL.
- SPACE CONSIDERED FOR ELECTRICAL & SAT CABLE TRENCH DURING THE DETAILED DESIGN STAGE ELECTRICAL & SAT CABLE TRENCH WILL BE PROVIDED BASED ON DESIGN.
- 1 IN 8.5 TURNOUTS PROVIDED IN THE DEPOT.
- FM DISTANCE PROVIDED AT 4.25M METERS.

NOTES:

- ALL DIMENSIONS ARE IN MM AND LEVELS ARE IN METER UNLESS STATED OTHERWISE.
 - THIS DRAWING SHALL NOT BE SCALED. ONLY WRITTEN DIMENSIONS TO BE FOLLOWED.
 - ALL WATER SUPPLY PIPES AND FITTINGS SHALL BE CPVC PIPES OF SDR 13.5 CONFORMING TO ASTM - D2846-2006.
 - ALL ANGLE VALVE SHALL BE 450 ABOVE FFL.
 - ALL WATER SUPPLY PIPES SHALL BE PROPERLY SUPPORTED/CLAMPED.
- SCHEDULE OF WATER SUPPLY PIPES & FIXTURES HEIGHTS
- FLUSH VALVE SHALL BE 1000 MM ABOVE FFL UNLESS OTHERWISE SPECIFIED.
 - ANGLE VALVES FOR HF SHALL BE 450 MM ABOVE FFL UNLESS OTHERWISE SPECIFIED.
 - ANGLE VALVES FOR WB SHALL BE 450 MM ABOVE FFL UNLESS OTHERWISE SPECIFIED.
 - BIB TAP SHALL BE 450 MM ABOVE FFL UNLESS OTHERWISE SPECIFIED.
 - SINK TAP SHALL BE 1000 MM ABOVE FFL UNLESS OTHERWISE SPECIFIED.

LEGEND:

SI NO	SYMBOL / NAME	DESCRIPTION
1	DWS	DOMESTIC WATER SUPPLY
2	FWS	FLUSHING WATER SUPPLY
3	(BT)	BIB TAP
4	(BV)	BALL VALVE
5	(DWS)	DOMESTIC WATER SUPPLY PIPE
6	(FWS)	FLUSHING WATER SUPPLY PIPE
7	(D)	DIRECTION OF FLOW
8	(R)	RISE OR DROP
9	(R)	PIPE REDUCER



BARSYL
BALAJI RAILROAD SYSTEMS (P) LIMITED.

REV NO	DESCRIPTION	DATE	DESIGNED	CHECKED	REVIEWED	APPROVED
1	TENDER DRAWING	12/05/2024	12/05/2024	12/05/2024	12/05/2024	12/05/2024

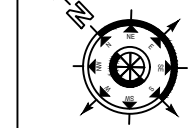

K RIDE
GENERAL CONSULTANT

PROJECT DIRECTOR	
SIGNALMENT EXPERT	
CHIEF TRACK EXPERT	
CHIEF SIGNALLING EXPERT	
CHIEF TRACTION EXPERT	
CHIEF TELECOM EXPERT	
SR ROLLING STOCK ENGINEER	



K RIDE
GM / PLANNING
GM / CIVIL / DEPOT
GM / ROLLING STOCK
GM / TRACTION
GM / SIGNALLING

K RIDE

DIRECTOR
PROJECT PLANNING

DIRECTOR SYSTEM

TENDER DRAWING			
PROJECT I.D. 2388			
TITLE: ANCILLARY SHED WATER SUPPLY LAYOUT			
CONSULTANT: BALAJI RAILROAD SYSTEMS (P) LIMITED.			
SCALE 1:250	SHEET NO. 1 OF 1	DRG NO. KRIDE_BSRP_RS_DEPOT_SEVA	REV 05